



This PDF is generated from authoritative online content, and is provided for convenience only. This PDF cannot be used for legal purposes. For authoritative understanding of what is and is not supported, always use the online content. To copy code samples, always use the online content.

Genesys Engage cloud Supervisor's Guide

Navigating Agent Desktop (v8)

Navigating Agent Desktop (v8)

Important

This content may not be the latest Genesys Engage cloud content. To find the latest content, go to [Genesys Engage cloud for Supervisors](#).

Having trouble finding your way around Agent Desktop? If you need help identifying a button or field, hold your mouse pointer over it to reveal a tooltip.

Do you use a screen reader? Do you navigate Agent Desktop using a keyboard? You can find out all about it [here!](#)

Main view

Link to video

The main view lets you access the most common features that you use every day, such as managing your channels, campaigns, KPIs, workbins contacts/customers, and messages.

Some of the tabs include:

- **My Channels** — Set your status on individual [channels](#), such as [voice](#), [chat](#), and [email](#).
- **My Campaigns** — View and manage your [Outbound campaigns](#).
- **My Statistics** — View your [statistics \(KPIs\) and alerts](#).
- **Contact Center Statistics** — View the latest [statistics and alerts for your contact center](#).

Watch the video for a quick tour of the Agent Desktop main view.

Supporting views

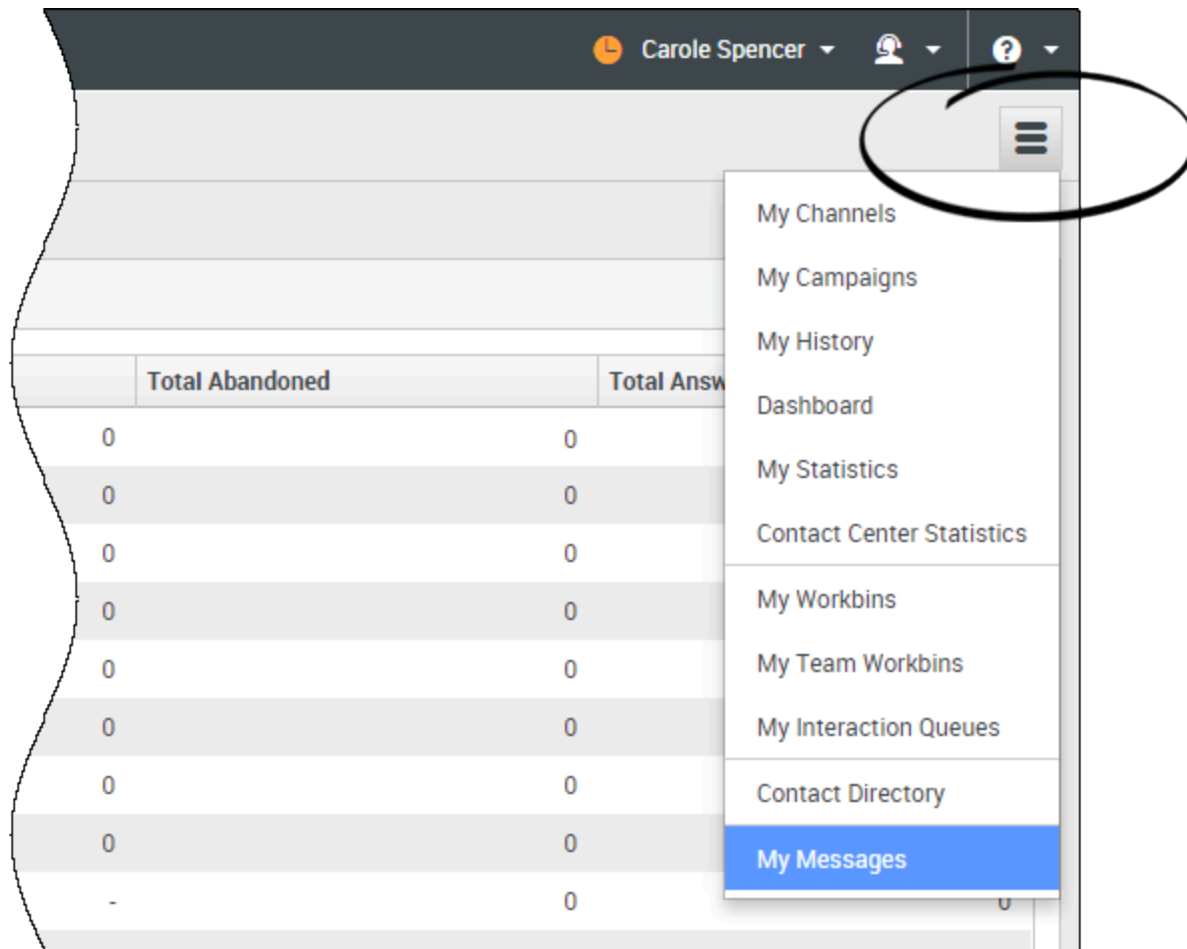

Use  to access all of the views available to you, including returning you to the tab views.

Contact Center Statistics and KPIs

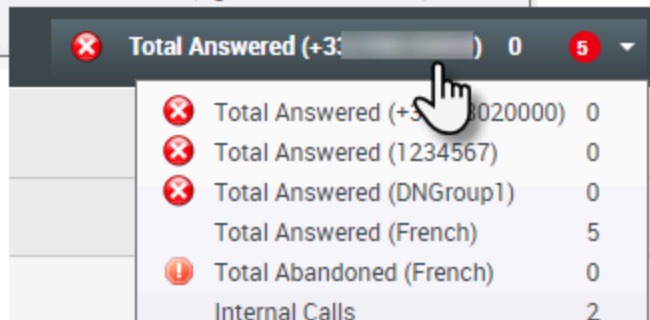
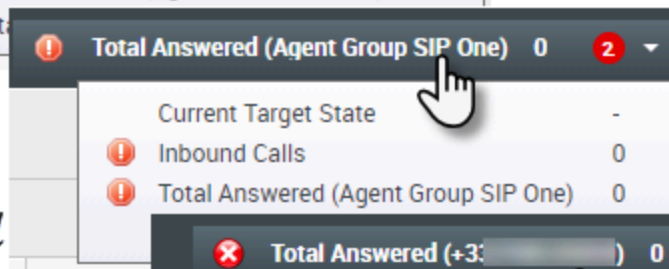
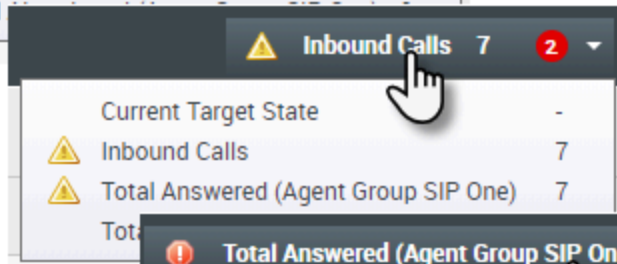
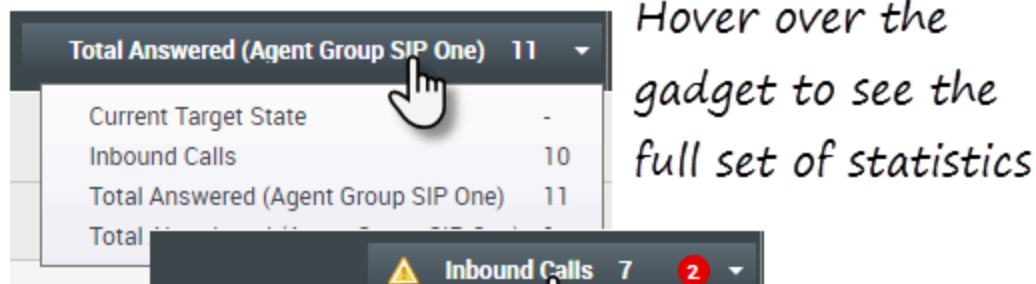
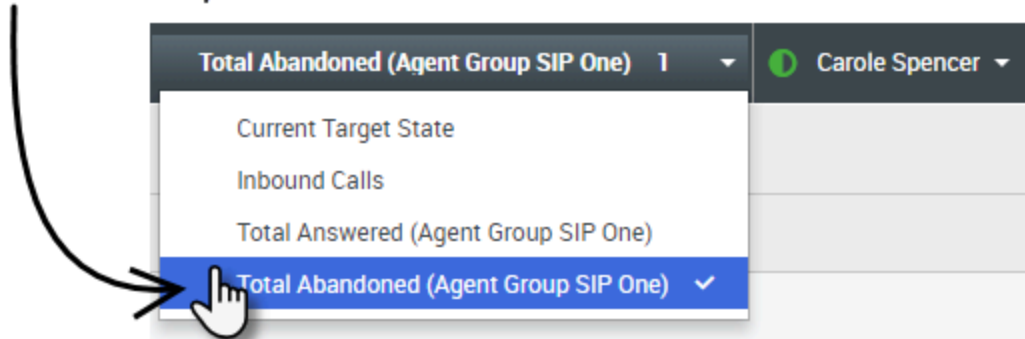
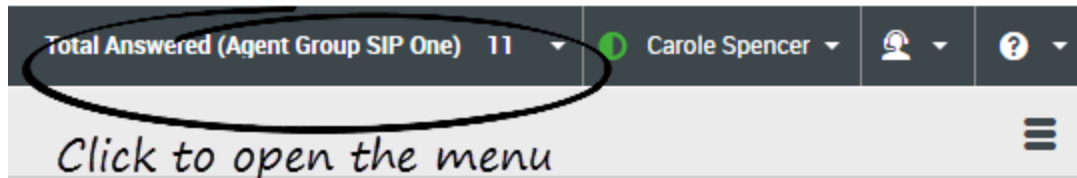

There are three places where you can view and track your performance and the performance of your contact center:

- The Statistics Gadget in the main menu bar
- The Contact Center Statistics tab in My Workspace
- The My Statistics tab in My Workspace

Note: Some or all of these features might not be available in your environment.

Statistics Gadget

The Statistics Gadget helps you to stay up to date on certain key statistics. Your administrator decides which statistics are available for you to view.

The Statistics Gadget displays one statistic at a time, giving you the current status of service level, number of calls waiting, number of calls you have handled, and so on.

Hover your mouse pointer over the Statistics Gadget to see the current values for all of the statistics that have been assigned to the gadget by your administrator.

The red circle with the number tells you how many alarms currently apply to the statistics being evaluated by the gadget.

If more than one statistic has been assigned to the gadget, click it to open a list of currently available statistics and select a different one to display. A check mark is displayed next to the current statistic.

Here are the icons that you might see in the Statistics Gadget, the Contact Center Statistics tab, and the My Statistics tab:

- A worst icon is displayed if the evaluation of the performance is the worst of your group (❗).
- An error icon is displayed if the evaluation of the performance is below the expected error level for the KPI (❌).
- A warning icon is displayed if the evaluation of your performance for the KPI goes beyond the expected warning level for the KPI (⚠️).

To see all of the statistics available for your contact center or for yourself (all your KPIs), click the appropriate tab in My Workspace. You can also choose these tabs from the Available Views (☰) menu.

Contact Center Statistics tab

The items displayed on this tab are statistics for Routing Points, Queues, and other contact center facilities.

The Contact Center Statistics tab displays statistics that summarize the state of various conditions, such as waiting time, calls in queue, average maximum waiting time, service level, and answered and abandoned calls, that are monitored by your contact center.

Click the **Contact Center Resource** column head to change the sort order of the resources.

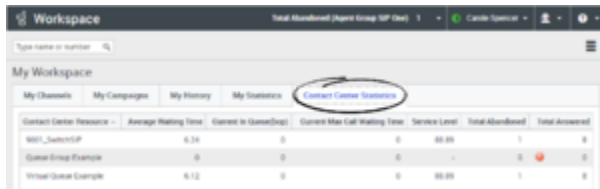

Contact Center Resource	Average Waiting Time	Current In Queue/Calls	Current Max Call Waiting Time	Service Level	Total Abandoned	Total Answered
W01_Sales/CP	6.34	0	0	99.85	1	0
Queue Group Example	0	0	0	-	0	0
Virtual Queue Example	6.12	0	0	99.85	1	0

My Statistics tab

This tab displays the list of your Key Performance Indicators (KPIs).

The KPIs that are displayed are set up by your system administrator. The statistics might be for your agent group rather than for you personally.

Click the **Objects** column heads to change the sort order of the KPIs.

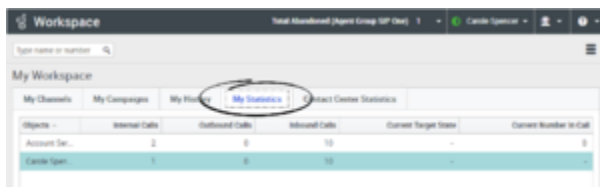

Objects	Internal Calls	Outbound Calls	Missed Calls	Current Target State	Current Number In Call
Account Ser...	2	0	10	-	0
Circle Open	1	0	10	-	0

Quick Search

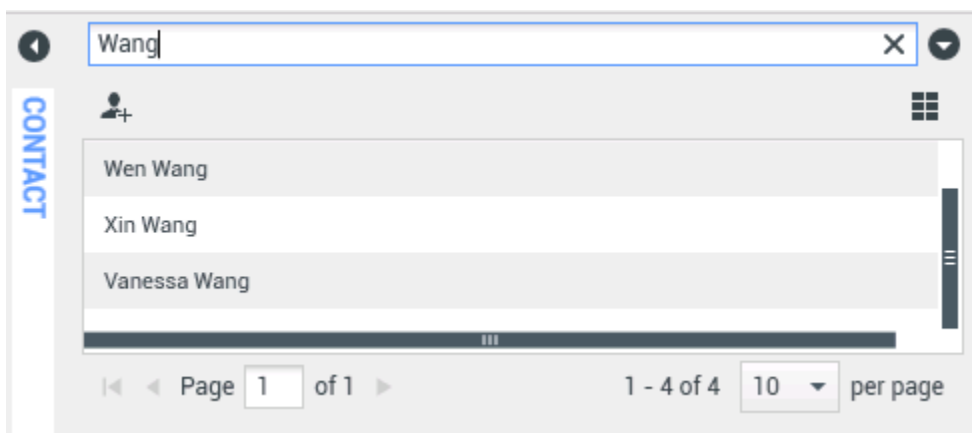

Wang

CONTACT

- Wen Wang
- Xin Wang
- Vanessa Wang

Page 1 of 1 1 - 4 of 4 10 per page

In the Quick Search field, you can enter the name or other information, such as a phone number or email address, of a contact, then click the magnifying-glass icon to begin the search of the contact

database.

Chronology slider



The chronology slider lets you search the contact history for interactions that took place within a certain time period. The slider has four positions:

- **All**—Search the entire database from the most recent interaction back to the earliest interaction
- **Last Month**—Search the database from the most recent interaction back to one month ago
- **Last Week**—Search the database from the most recent interaction back to one week ago
- **Last Day**—Search the database from the most recent interaction back to one day ago

Page controls

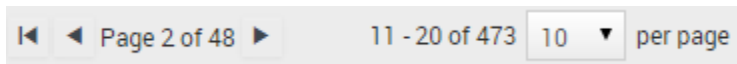

Page through the list of search results by doing any of the following:

- **Go to the Next Page** (▶)
- **Go to the Previous Page** (◀)
- **Go to First Page** (◀◀)
- Specify the number of items that are displayed on each page by using the **per page** drop-down list.

List and Grid views

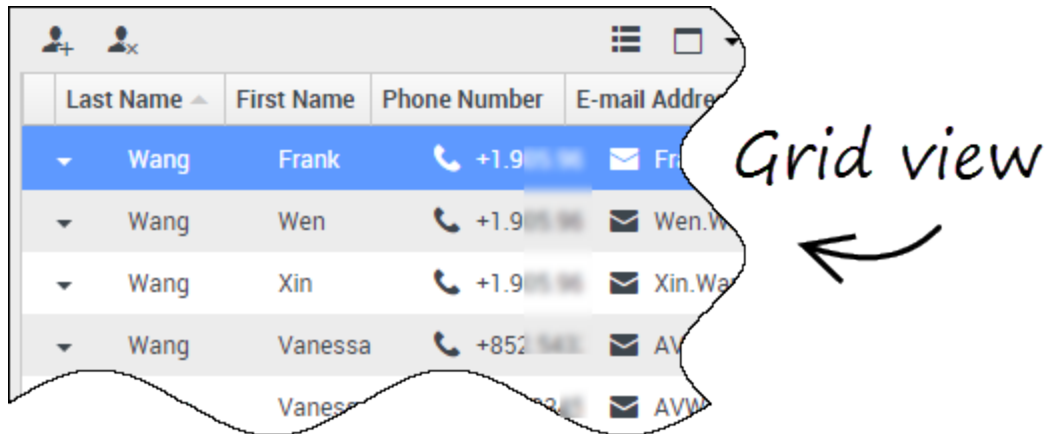

The List view displays an unsorted list of all of the contacts in the contact database that match the search criteria.

Grid mode results are returned in tabular form and sorted according to the default search field, such as Last Name. The Grid view can be used to help to refine your search by sorting the results.

Click a column head in the Grid view to sort the list based on that criterion. Click a column head a second time to switch between ascending and descending sort order.

Show/Hide panel details

The **Show Details Panel on Bottom/Hide Details Panel** button () enables you to specify how the Details panel is displayed. The details panel can be shown or hidden, and, when shown, can be displayed below or to the right of the window.

Click the **Show Details Panel on Bottom/Hide Details Panel** button to choose one of the following views:

- —Displays the Details panel below the workspace area.
- —Hides the Details panel.

Interaction Bar



The Interaction Bar is displayed in the main view whenever you have one or more active interactions. If you have multiple active interactions, only the tools for the current active interaction are displayed. The toolbar for other active interactions collapse until you click them to make them current.

Each interaction is represented by a control bar. You can use the control bar to perform basic actions that are specific to the interaction type, such as ending a call.

- Click the control bar for an interaction to give it the focus. All other open interactions are collapsed to the Interaction Bar.
- Click the small colored bar on the left of the interaction control to toggle between pinned mode and floating mode. In floating mode, other open views appear dimmed behind the interaction view.

Entries in the Interaction Bar flash (or blink) when specific events occur that might require your immediate attention.

Tip: To allow for the maximum space in the Interaction Bar, when you are handling an interaction, the **Team Communicator** is reduced to a button.





Team Communicator

[Link to video](#)

Team Communicator lets you find someone in your company's internal directory (such as a team member, a routing point, or an agent group), and sometimes someone outside your company, such as an external resource person or even a customer contact. It's useful for getting help or consulting with someone while working with an interaction.

To start a **call** or **email** interaction, just click in the Team Communicator search field and start typing a name, number, or email address.

You can also filter the search results:

-  to search all contacts
-  to search your favorites
-  to search recent contacts
-  to group (or ungroup) your results by category or type

If you miss a call, the clock button changes to orange, like this: . Click it to display any missed calls. If you hover your mouse pointer over the contact entry, a tooltip displays the missed call information, including date, time, and known contact details.

Tip: When you close the Team Communicator, or if you switch the filter to All contacts or Favorite contacts, the **Recent** button changes back to white if you have viewed your recent and missed calls, or if you have called back all of your missed calls.

Watch the video for a short demonstration of how to use Team Communicator.

Party Action menu

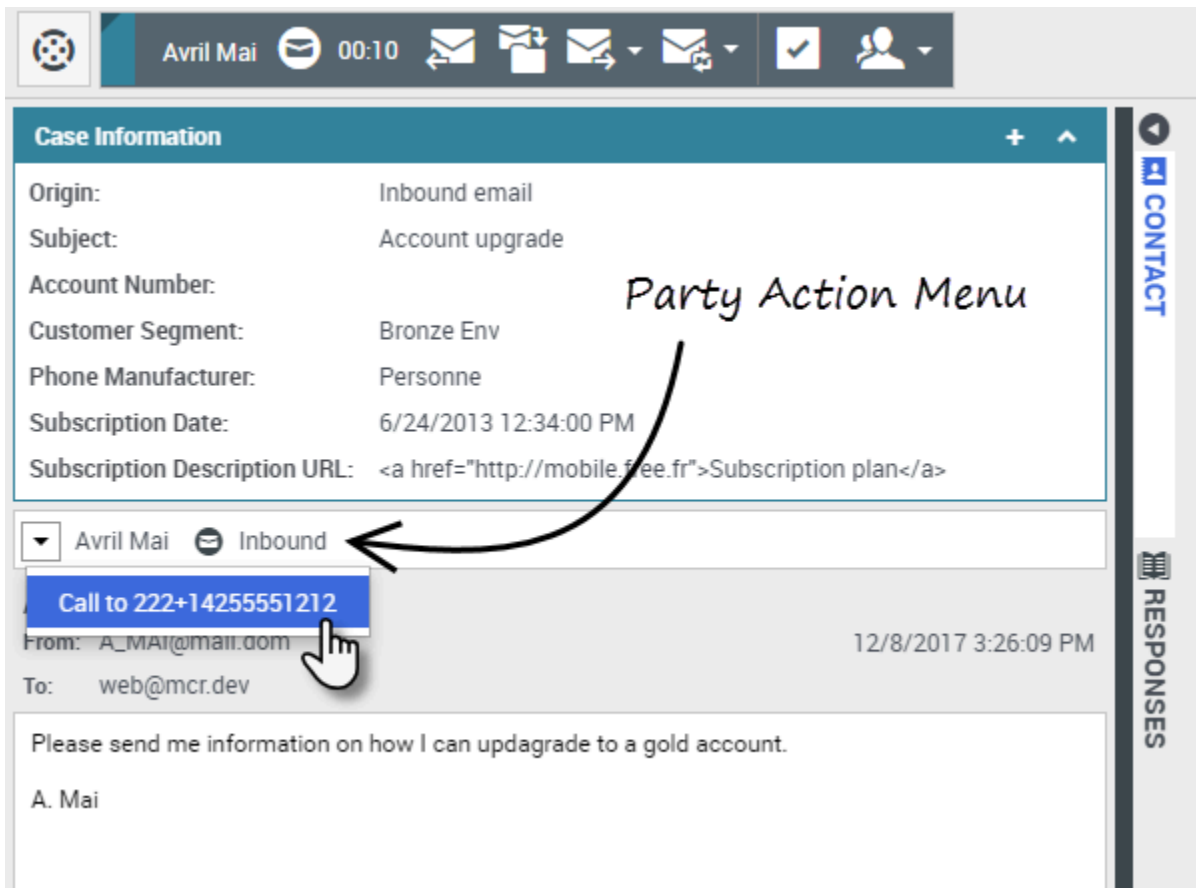

The **Party Action** menu is a part of every interaction. You can use it during an interaction to launch a secondary interaction. For example, while you are handling an email interaction from a contact, you can use the **Party Action** menu to call the contact if their phone number address is stored in your corporate database.

How to provide feedback when something goes wrong

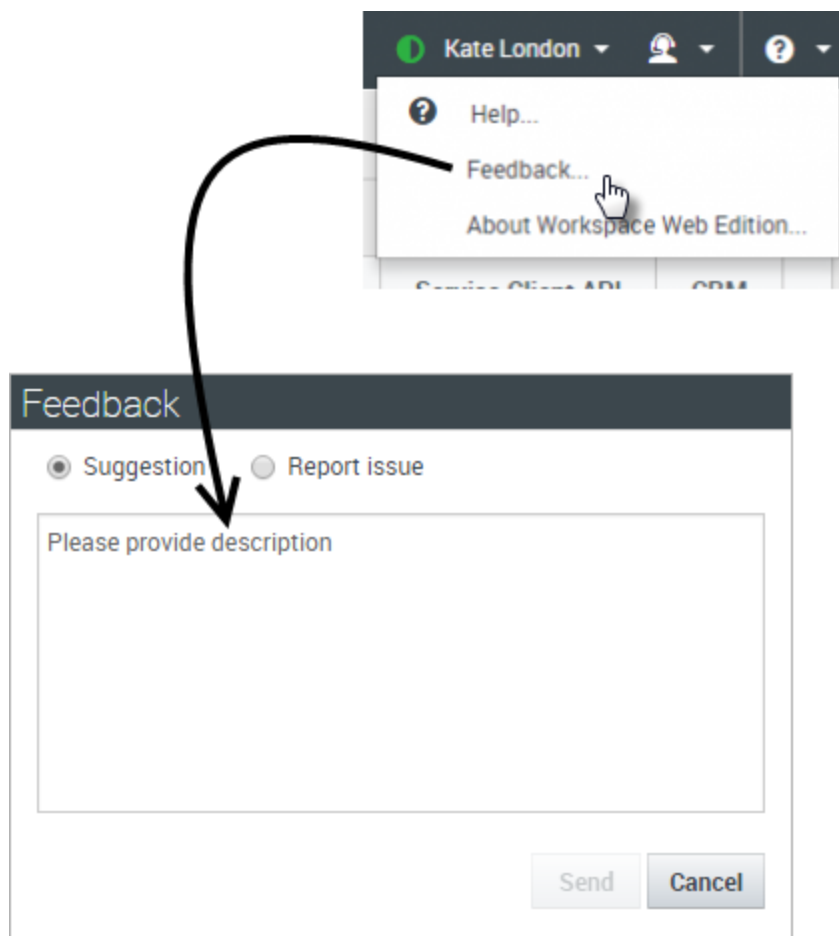

Sometimes web-based applications don't work as expected. There might be network connection issues, or the system that sends you phone calls, emails, and chats might be slow or behaving in odd ways. Sometimes the sound quality of a phone call is bad. Sometimes an error message is displayed on your desktop.

These and other issues are problems that you should report to your supervisor. Open the **Help** menu and select **Feedback** to open the **Feedback** window. Choose the type of feedback that you want to give, either a suggestion or to report an issue, describe the problem or suggestion by typing in the text box, then click **Send** to submit your feedback. This information, along with logs about what you were doing in your most recent Agent Desktop session, are sent to Genesys and are available to Customer Care for later reference.

If for some reason Agent Desktop becomes disconnected from your network and you have to close your browser and launch a new one to log in again, Agent Desktop automatically opens the **Feedback** window to let you write a report about the disconnection problem immediately.

Once a feedback report is logged to you as a supervisor, contact Genesys Customer Care as soon as possible to provide the reporting user's name and DN at the time of the incident, as well as the approximate time the incident occurred. The Customer Care agent should be able to retrieve the

relevant log to determine what the issue might have been.

Keyboard navigation and accessibility

Agent Desktop lets you navigate the interface entirely by keyboard. This means that you don't have to use a mouse to activate different features or select buttons.

It also means that you can use a screen-reader application to perform all the functions you need.

Whenever an event happens in Agent Desktop, like you get a new interaction or an error message is displayed, Agent Desktop makes a sound to alert you.

All the different ways that you can use the keyboard and a screen-reader to move around are described in this section.

Agent Desktop lets you use keyboard shortcuts combinations for some common actions. Ask your administrator for a list of the shortcuts that are set up for Agent Desktop.

Shortcut key combinations

A shortcut is a combination of keys that you press to make something happen in an Agent Desktop window.

OS shortcuts

The computer operating system also has shortcut keys to let you copy, cut, paste, undo, delete, find, maximize window, minimize window, open menu and select command, switch application, cancel, change focus, and so on. Consult your operating-system documentation for a list of supported keyboard shortcuts.

Agent Desktop shortcut keys

Agent Desktop supports three shortcut key combinations that you can use to make you more productive. These are the default shortcuts (your administrator might have set up different shortcuts for you):

- **Alt+N** — Jump to the next interaction if you have multiple interactions open
- **Alt+B** — Jump to the previous interaction if you have multiple interactions open
- **Alt+L** — Jump to the last error message that you received

Keyboard navigation

Agent Desktop supports keyboard navigation for all features, functions, options, and menus.

If you do not use a mouse or if you are using a device for accessibility that needs keyboard navigation, you can still use all the Agent Desktop features. Many *expert users* prefer to use keyboard navigation to maximize productivity.

Colors and appearance change as you select different items on the Agent Desktop. For example, buttons change color and menus open with the current selection highlighted by color.

Basic navigation using the TAB key

The simplest way to navigate by keyboard is to use the **TAB** and **SHIFT+TAB** keys.

- **Tab**—Moves your focus to the next menu, field, button, view, and so on.
- **Shift + Tab**—Moves your focus to the previous menu, field, button, view, and so on.

Movement occurs from left to right and from top to bottom, unless the ordering of components dictates otherwise. Navigation moves from component to component within a view, and from view to view within the application.

Navigation Shortcuts

This table shows you the keyboard shortcuts that let you control Agent Desktop without using a mouse.

Agent Desktop keyboard shortcuts

Shortcut	Description
Left Arrow	<ul style="list-style-type: none"> • Move left in a menu bar or out of a submenu. • Move to the next tab on the left. • Move left in the history slider.
Right Arrow	<ul style="list-style-type: none"> • Move right in a menu bar or out of a submenu. • Move to the next tab on the right. • Move right in the history slider.

Shortcut	Description
Up Arrow	Move up in lists and menus.
Down Arrow	Move down in lists and menus.
Alt+Down Arrow	Open a selected drop-down list.
Enter	For a modifiable list, apply the edit mode, or validate the modification. For a button, execute the associated action. For a menu item, execute the associated action.
Space	For some controls, select or clear the check box that has the focus.
Escape	For a modifiable list, cancel the edit mode.